

Features:

- **MOV provides spike and surge protection.**
- **Magnetic bond sensor monitor output.**
- **Bi-color LED indicates lock/unlock status.**
- **Anodized aluminum housing.**
- **Adjustable mounting plate for easy installation.**
- **Dual voltage 12 or 24 VDC (selectable) .**
- **Anti-Residual magnetism designed.**
- **Complete mounting hardware included.**

Statement:

10002 mini electromagnetic locks are manufactured under GEM's ISO 9001 Certified Quality Management Program environment back its product quality, performance and commitment to customer satisfaction.

The fail-safe Electromagnetic Lock design with no mechanical parts but magnetic force to secure and release the doors, suitable for use in areas which required access controlled or egress such as exit door.

We offers up to 600 pounds holding force with jumper pin selectable for 12V or 24V DC dual input voltage and can be applied with access control, and with the full range of optional brackets, it can be installed on any type of door frames such as narrow door frame, in-swinging door and glasses door. Build in magnetic bond sensor output and bi-colour LED indicates the door locked or unlocked status.

It is the best choice for electronic security industry and system integrators. More optional functions are available in 10002 mini electromagnetic lock series.

Specifications:

- Voltage Tolerance: $\pm 15\%$
- Current Draw: 500mA@12Vdc ; 250mA@24Vdc (at temperature 20°C)
- Magnetic bond sensor monitor output (SPDT rated 3A@12V DC), remotely monitors the door lock or unlock status. (N.C. Output--Door opened; N.O. Output--Door closed)
- Status LED: Lights GREEN when the door is unlocked, lights RED when the door is locked.
- Operating Temperature: -10~55°C (14~131°F)
- Humidity: 0~95% non-condensing.
- Lock's surface Temperature (when the power is on): \leq current temperature +20°C
- Holding Force: Up to 600 lbs (272 Kg)
- Dimensions:
 - Magnet:(L) 250, (W) 42, (D) 26 mm
 - Armature Plate:(L) 185, (W) 38, (D) 12 mm
 - Mounting Plate:(L) 250, (W) 25, (D) 5 mm
- Special Finishes for magnet and armature plate: Zinc
- Epoxy Potting Compound: E87252 (S), UL94V-0
- Weight (Approx.) : 2.0 Kg



Regular Installation

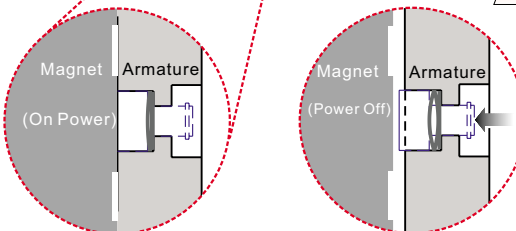
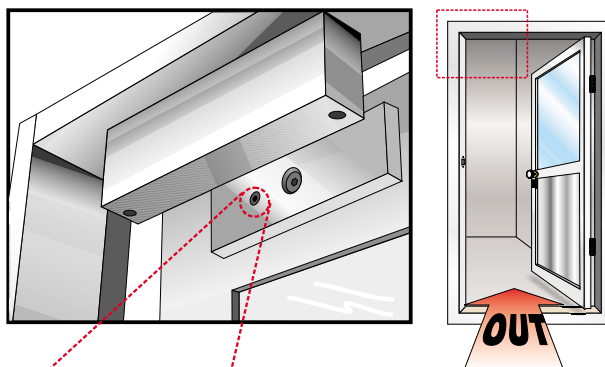

Unique Anti-Residual design

When there is no power, there will be no holding force, and the push-off button will pop out immediately, to release the Electromagnetic Lock and the Armature Plate for no residual magnetism.

Warranty:

GEM Electromagnetic Locks are warranted against defects in material and workmanship while used in normal service for a period of 5 years from the date of sale to the original customer.

GIANNI INDUSTRIES, INC.

No.306-1, Hsin Shu Road, Hsin Chuang, Taipei,Taiwan 242
 TEL: 886-2-2206 9929 FAX: 886-2-2204 6632
 E-Mail: info@gianni.com.tw
 Website: www.gianni.com.tw

Copyright all rights reserved
 DM-CA-2004-10002 Ver. A Publish:2005.12.22



The products are manufactured under an ISO 9001 Certified Quality Management Program environment back its product quality, performance and commitment to customer satisfaction.

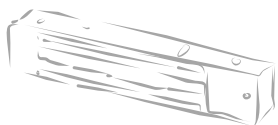

Optional Brackets:

Identify the door swinging direction and inspect the door frame header to determine if bracket is required. A L-brackets, LZ-brackets or U-brackets may be required for the electromagnet depending on the frame header and swinging direction.

With L-bracket for narrow door frames

When "A" < 42 mm, must installed with "L" brackets.

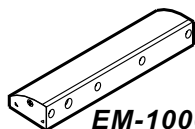
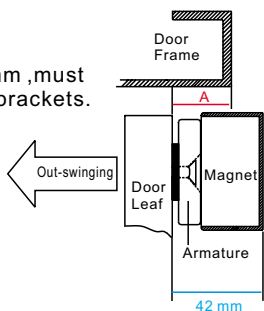

EM-10001L

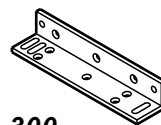

L-300

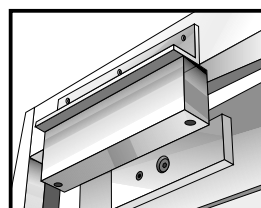
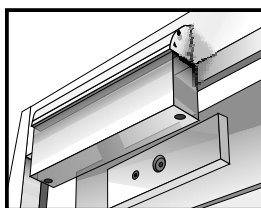

With LZ-bracket for in-swinging doors

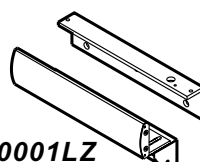
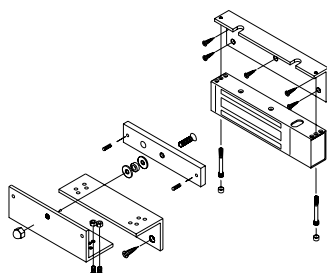
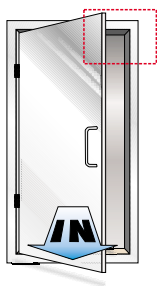

EM-10001LZ

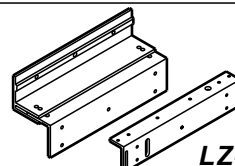

LZ-300N

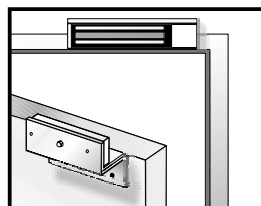
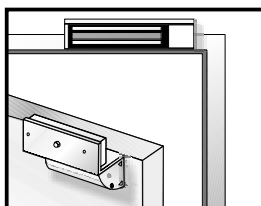

With U-bracket for frameless glass doors

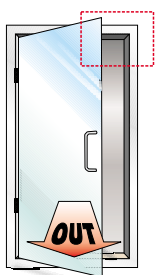

UBK-010

For 10mm thickness of glass door

UBK-012

For 12mm thickness of glass door

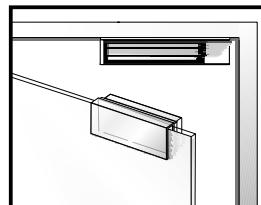

Disclaimer:

The information and specifications printed in this manual are current at the time of publication. The GEM policy is one of continual development and improvement; therefore GEM reserves the right to change specifications without notice.

GIANNI INDUSTRIES, INC.

No.306-1, Hsin Shu Road, Hsin Chuang, Taipei, Taiwan 242
TEL: 886-2-2206 9929 FAX: 886-2-2204 6632
E-Mail: info@gianni.com.tw
Website: www.gianni.com.tw

Copyright all rights reserved
DM-CA-2004-10002 Ver. A Publish:2005.12.22



The products are manufactured under an ISO 9001 Certified Quality Management Program environment back its product quality, performance and commitment to customer satisfaction.