

# emotion

---

**LENS**

**Aisi316L stainless steel body**  
**Pan/Tilt unit with integrated receiver**  
**Continuous rotation**  
**IP66**  
**Variable speed from 0.01 ° to 200 %/s**  
**Onscreen display configuration**  
**Multiprotocol**

Emotion is the new series of PTZ devices particularly sturdy and dedicated to video surveillance for indoor and outdoor applications especially where the specify resistance to corrosion guaranteed by AISI 316L Stainless Steel is required.

The unit is easy to install, versatile and customizable.

Emotion can host analog cameras with motorized lenses, block module cameras with serial control and thermal cameras.

Continuous PAN and TILT rotations.

Positioning is extremely quick thanks to the speed that can reach 200 %/sec on both axis.

The unit works with mechanical solutions that do not require maintenance.



**tekno system®**  
Italian design for CCTV since 1979

**Tekno System S.p.A.**

Via Rostoncello, 1 - 36010 Carrè – Italy

Phone: +39 0445 314324 | Fax: +39 0445 314319

Email: [info@teknoystem.eu](mailto:info@teknoystem.eu) | Web: [www.teknoystem.eu](http://www.teknoystem.eu)

rev. 110612

Page 1 / 6

MECHANICAL FEATURES
Entirely made of stainless steel Aisi316L
Top mount
Tooth belt transmission
Slip-ring
Zero backlash
Horizontal continuous rotation
Vertical continuous rotation
Electronic limit switches
Pan and tilt speed from 0.01 °up to 200 °/s(*)
Angular acceleration 250 °/s <sup>2</sup> – 1000 °/s <sup>2</sup>
Position repeat accuracy +/-0.01 °
Inner dimensions (see drawings)
Useful window (see drawing)
User friendly installation
4 cable glands M16
(*) related to model/version and to the load weight
ELECTRICAL FEATURES
CONSUMPTION
24Vac, 50/60Hz 120W 5A
120Vac, 50/60Hz 120W 1A
230Vac, 50/60Hz 120W 0,5A
CAMERA
12Vdc-800mA
Lenses 6-12Vdc-200mA (polarity inversion lenses)
Camera protection in case of system switching on with uncorrect temperature
VIDEO
Up to 2 video lines (1V, 75Ω)
SERIAL INTERFACES
Two serial ports RS485
<i>Every serial port may handle up to 4095 addresses depending on the protocol utilized</i>
FIELD INTERFACE
nr.4 alarm input (10-35V)
nr.4 open collector output
SOFTWARE
Software for system configuration, languages configuration, upgrade through serial RS485 in remote modality.

MAIN FUNCTIONS
SYSTEM
Multilanguages OSD configuration.
Up to 5 languages to be customized by the customer.
250 Preset (related to protocol)
23 characters available for title
Patrol sequences and random
Automatic recall on event
TELEMETRY PROTOCOLS
Pelco D, Pelco P, American Dynamics, Panasonic
<i>Trademark are registered and belong to their owners.</i>
<i>Other protocols under request</i>
CAMERA PROTOCOLS
VISCA (Sony), Flir, Pelco D, Pelco P
<i>Trademark are registered and belong to their owners.</i>
<i>Other protocols under request</i>
ENVIRONMENT
For indoor and outdoor applications
Temperature range: -40 °C/+50 °C
Defogging System
CERTIFICATES
CEI EN60950-1, EN61000-6-3 e EN50130-4
FCC part 15, class B
IP66 EN60529
DIMENSIONS
Weight: 27kg
Box weight: 30kg
Box dimensions: 723x433x330mm

EMOTION can be interfaced with devices not made by Tekno System.  
 Due to the continuous evolution of the communication protocols it is compulsory to take the checking test to verify the compatibility of them with the Emotion before installation  
 Tekno System will not be responsible in any case of damages or costs due to eventual compatibility problems

## SERIAL CONNECTIONS

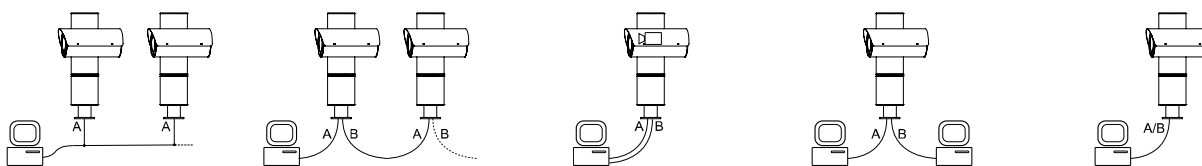

RS485

- Monodirectional
- Half/Duplex

RS485

- Monodirectional
- Half/Duplex

Daisy chain connection  
up to 1,2km for each  
connection

2 RS485

- Monodirectional
- Half/Duplex

Direct connection to  
camera (optional)

RS485

- Monodirectional
- Half/Duplex

With 2 different  
protocols

RS422

*Every configuration may handle up to 4095 addresses depending on the protocol utilized*

## MODELS

EMOTION LENS 24VAC

Stainless steel Aisi316L integrated positioning unit Emotion, feeding voltage 24Vac, for analog cameras with motorized zoom and serial interface.

EMOTION LENS 230VAC

Stainless steel Aisi316L integrated positioning unit Emotion, feeding voltage 230Vac, for analog cameras with motorized zoom and serial interface.

EMOTION LENS 24VAC WIPER

Stainless steel Aisi316L integrated positioning unit Emotion, feeding voltage 24Vac, wiper, for analog cameras with motorized zoom and serial interface.

EMOTION LENS 230VAC WIPER

Stainless steel Aisi316L integrated positioning unit Emotion, feeding voltage 230Vac, wiper, for analog cameras with motorized zoom and serial interface.

**tekno system®**

Italian design for CCTV since 1979

**Tekno System S.p.A.**

Via Rostoncello, 1 - 36010 Carrè – Italy

Phone: +39 0445 314324 | Fax: +39 0445 314319

Email: [info@teknoSYSTEM.eu](mailto:info@teknoSYSTEM.eu) | Web: [www.teknoSYSTEM.eu](http://www.teknoSYSTEM.eu)

rev. 110612

Page 3 / 6

## Dimensional drawings

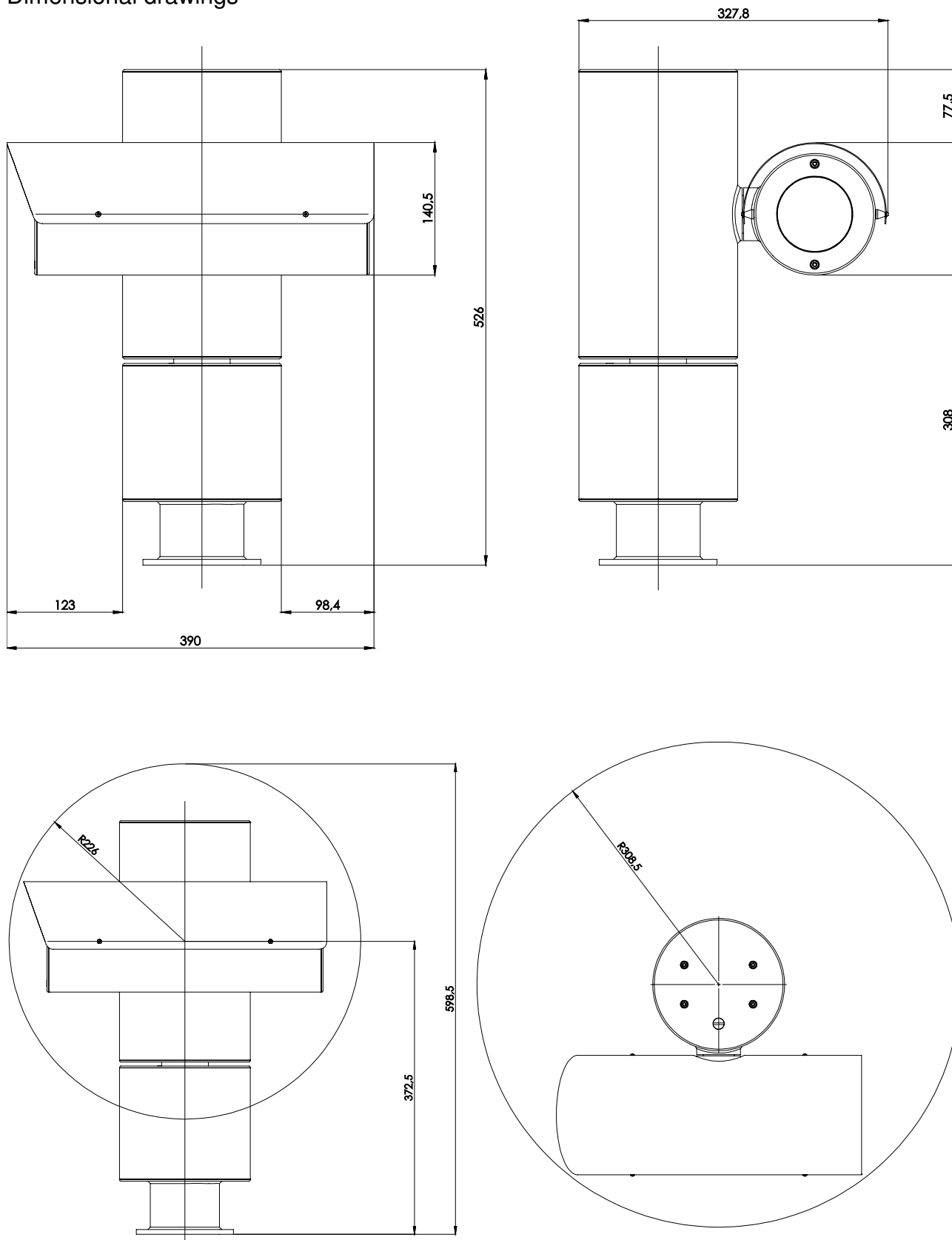

**tekno system®**  
Italian design for CCTV since 1979

**Tekno System S.p.A.**

Via Rostoncello, 1 - 36010 Carrè – Italy

Phone: +39 0445 314324 | Fax: +39 0445 314319

Email: [info@teknoystem.eu](mailto:info@teknoystem.eu) | Web: [www.teknoystem.eu](http://www.teknoystem.eu)

rev. 110612

Page 4 / 6

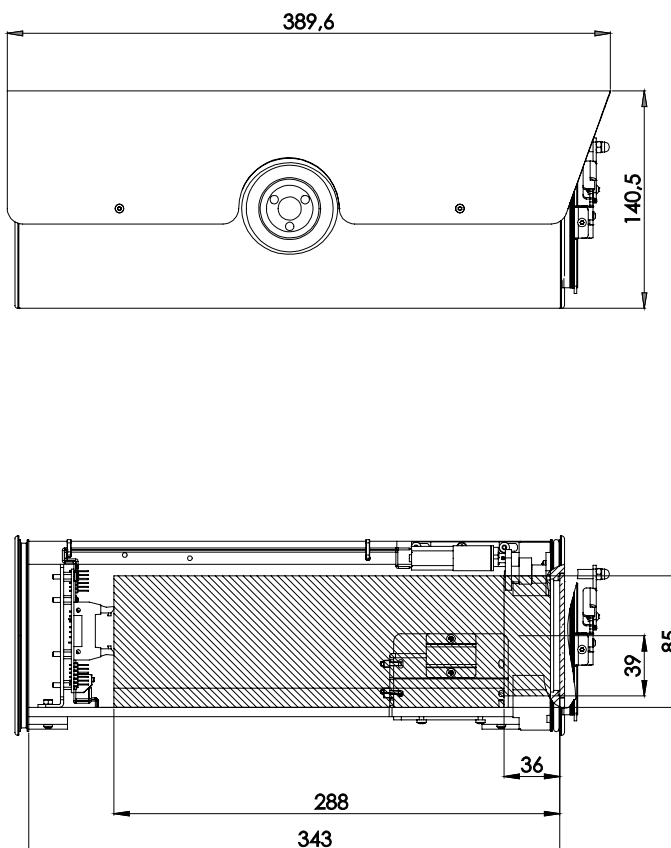
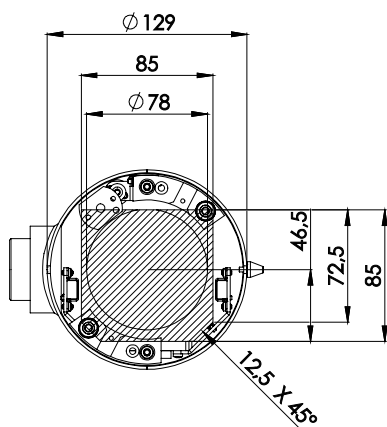
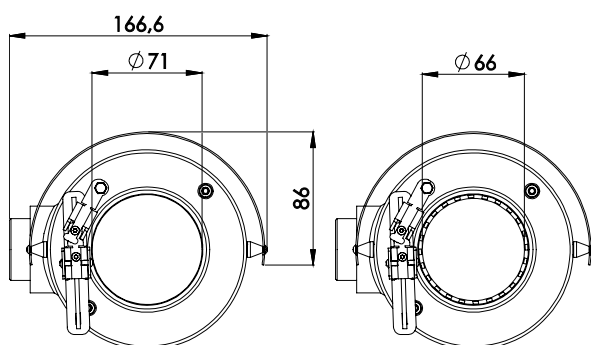
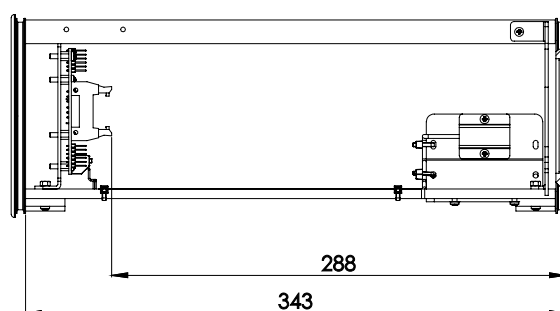
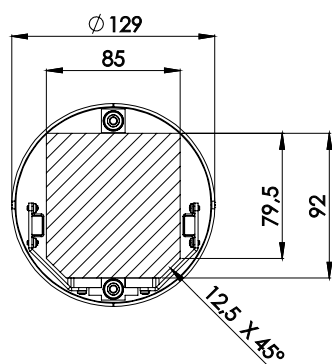
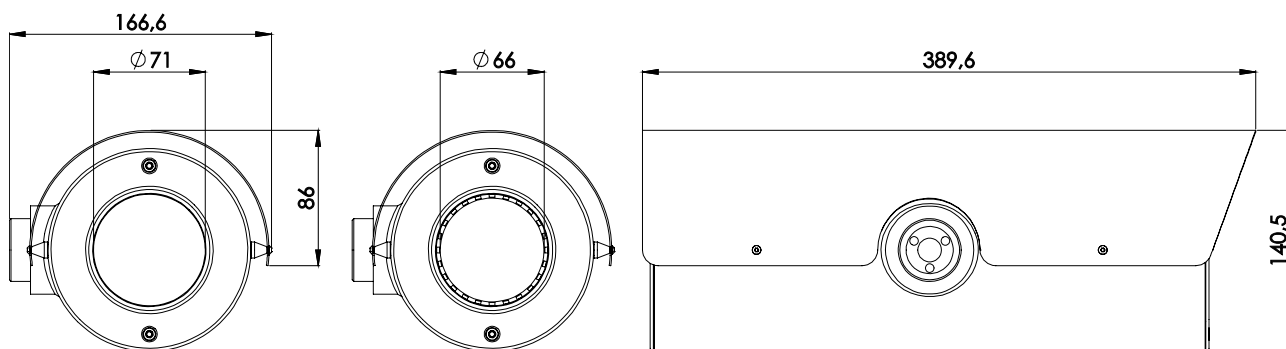

**tekno system®**  
Italian design for CCTV since 1979

**Tekno System S.p.A.**

Via Rostoncello, 1 - 36010 Carrè – Italy

Phone: +39 0445 314324 | Fax: +39 0445 314319

Email: [info@teknoSYSTEM.eu](mailto:info@teknoSYSTEM.eu) | Web: [www.teknoSYSTEM.eu](http://www.teknoSYSTEM.eu)

rev. 110612

Page 5 / 6

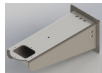
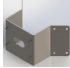
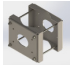
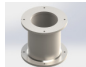

**ACCESSORIES**

BWE	AISI316L Stainless Steel Wall Bracket for Emotion	
CME	AISI316L Stainless Steel Corner Adapter for Emotion	
PAE	AISI316 Stainless Steel Pole Mount Adapter for Emotion	
TPE	AISI316 Stainless Steel Top Pole Mount Adapter for Emotion	

**RELATED PRODUCTS**

TSK1	Multiprotocol Control Keyboard LCD graphic display 3 serial ports RS485 Proportional 3 axis joystick (PTZ) Jog.shuttle Numeric keypad (12 keys) Multi-function keypad (10 keys)	
------	---	---

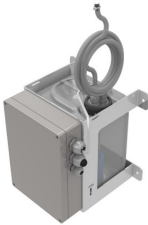
**WATER TANK AND PUMP** *(for Emotion with Wiper)*

TAP 5LX5M	5 Liters Water tank with 5 meters prevalence pump	
TAP 5LX5M WT	5 Liters Water tank with 5 meters prevalence pump and telemetry receiver	
TAP 25LX18M	25 Liters Water tank with 18 meters prevalence pump	
TAP 25LX18M WT	25 Liters Water tank with 18 meters prevalence pump and telemetry receiver	
EATAP	Stainless Steel Adapter to use Emotion with Water Tank and Pump when the BWE Bracket is not used. For example Top Mount on a Pole.	

